

AutoSense Micra 100

High sensitivity aspirating smoke detector
Product datasheet

Features

- Small, low cost aspirating smoke detector for easy and discreet installation
- Small, low cost aspirating smoke detector for easy and discreet installation
- Unique ClassiFire® Perceptive Artificial Intelligence system that dynamically adjusts the detector's operating parameters, allowing for day to day changes in the protected environment and dust separation system contamination
- Unwanted alarms from dust are avoided using patented Dual Technology LDD 3D Laser Dust Discrimination and elimination system
- Two sampling pipes (100m aggregate) for flexibility

Applications

- Data storage units
- Prison cells
- Air conditioning units
- Equipment racks
- Computer rooms
- Air duct protection
- Heritage property protection
- Critical equipment
- Anti-smoking enforcement

Principle

AutoSense Micra 100 is designed to provide very high sensitivity smoke detection in a small package.

ClassiFire Perceptive Artificial Intelligence ensures that the detector operates at optimum sensitivity for the protected environment, without the need for complex setup. This means the product will configure itself to provide high sensitivity in a computer room or reduced sensitivity in a smoky area.

The detector is designed to fit into a Docking Station. All sampling pipes and cables are connected to the Docking Station as a first fix operation leaving the detector to be fitted during the final commissioning phase if required. This ensures that detectors are less likely to be damaged during the installation.



AutoSense Micra 100 is delivered with piped exhaust docking station.

Technical specifications	
Supply Voltage	21.6 V - 26.4 VDC
Current consumption	400 mA @ 24 VDC
Size (mm)	300W x 220H x 85D
Weight	3.8 kg
Operating temperature range	-10 to +38°C (UL268) -10 to +60°C (CEA4022)
Operating humidity range	0 - 90% Non Condensing
Sensitivity range (%Obs/m)	Min = 0.003% Max = 25%
Maximum sensitivity resolution	0.0015 % obs/m
Detection principle	Laser light scattering mass detection and particle evaluation
Particle sensitivity range	0.003µm to 10µm
Dust discrimination principle	3D Laser Dust Discrimination (LDD)
Maximum sampling pipe length	50m moving air 100m still air
Sampling pipe inlets	2
Sampling pipe internal diameter	15 - 25 mm
Recommended no. of sampling holes	Max. 20 per pipe
Exhaust air pipe outlets	1, on optional Piped Exhaust docking station
Alarm levels	4 (Fire 2, Fire 1, PreAlarm and Aux)
Alarm outputs	1 relay as standard, others available
Relay contact rating	500 mA @ 30 V
Chamber service intervals	Greater than 10 years (dependent on environment)
Dust separator replacement intervals	Greater than 5 years (dependent on environment)
Laser lifetime (MTTF)	Greater than 1000 years
Protection degree	IP50
Programming	PC via RS232/RS485
Network databus	RS485
Data bus cable	RS485 data cable
Data bus length	1.2 km

Dimensions of piped exhaust docking station

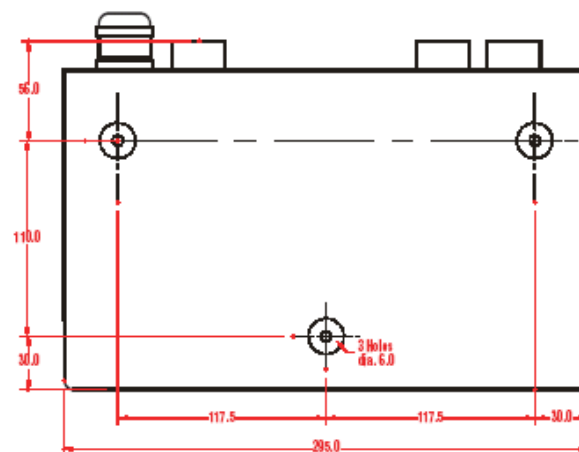
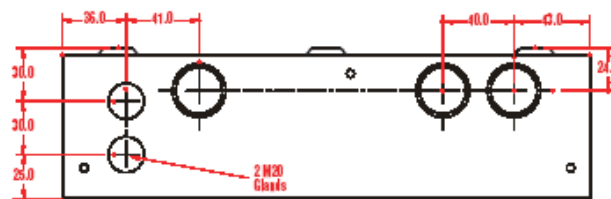

Leave 80 mm clearance at top and bottom of docking station for access

Part number	Description
116-5861-018.1107	AutoSense Micra 100 w/dockst., english