

FIXED MOUNTING BRACKET 45 DEGREE - BGMB45 FOR BG-301 FLAME DETECTOR

Product Datasheet

Features

- Used for easily mounting the AutoFlame IR3 Flame Detector BG-301 on to the wall
- Points downwards in a fixed 45 degree angle
- For outdoor use a Weather Bracket can be used
- Robust powder coated Aluminum

Description / Application

The Fixed Mounting Bracket is used for mounting the AutoFlame IR3 Flame Detector on to the wall.

When mounted, the flame detector will point downwards in a fixed 45 degree angle.

The flame detector can be mounted directly to the mounting bracket for indoor use, or together with a Weather Bracket, part no. 116-BGWB, for outdoor use. Screws for mounting detector are included.



For more details, see "Technical Handbook" for the AutoFlame IR3 Flame Detector BG-301.

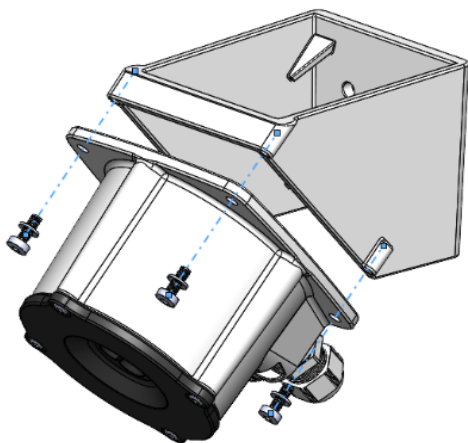

Side view of the bracket with the flame detector.
Indoor use

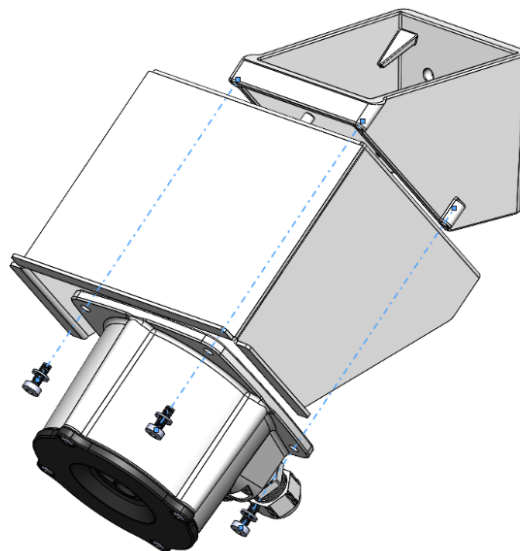

Side view of the bracket with the Weather Bracket
and flame detector.
Outdoor use

Fixed Mounting Bracket 45 Degree for BG-301 Flame Detector

Technical Specifications	
Dimensions	(see dimension drawing)
Weight	530 g
Materials	Aluminum
Color	RAL 9003
Mounting screws for detector	4 x MACHINE SCREW TX ISO 14583 M5 X 12mm A4 4 x LOCK WASHER - DIN 6798A - 5,3mm - A4

Accessories – Part Numbers

Name	Part Number	Description
Fixed Mounting Bracket, 45 degree for BG-301 Flame Detector	116-BGMB45	For volumetric surveillance, fixes the flame detector at a 45° angle. Including 4 mountings screws and lock washers for mounting detector
Other accessories		
Ball Joint Mounting Bracket for BG-301 Flame Detector	116-BGBJMB	The ball joint on the bracket allows you to flexibly adjust the bracket/flame detector both vertically and horizontally. Including 4 mountings screws and lock washers for mounting detector
Weather Bracket for BG-301 Flame Detector	116-BGWB	For outdoor applications.

Dimensions (mm)

Hole dimensions for wall mounting

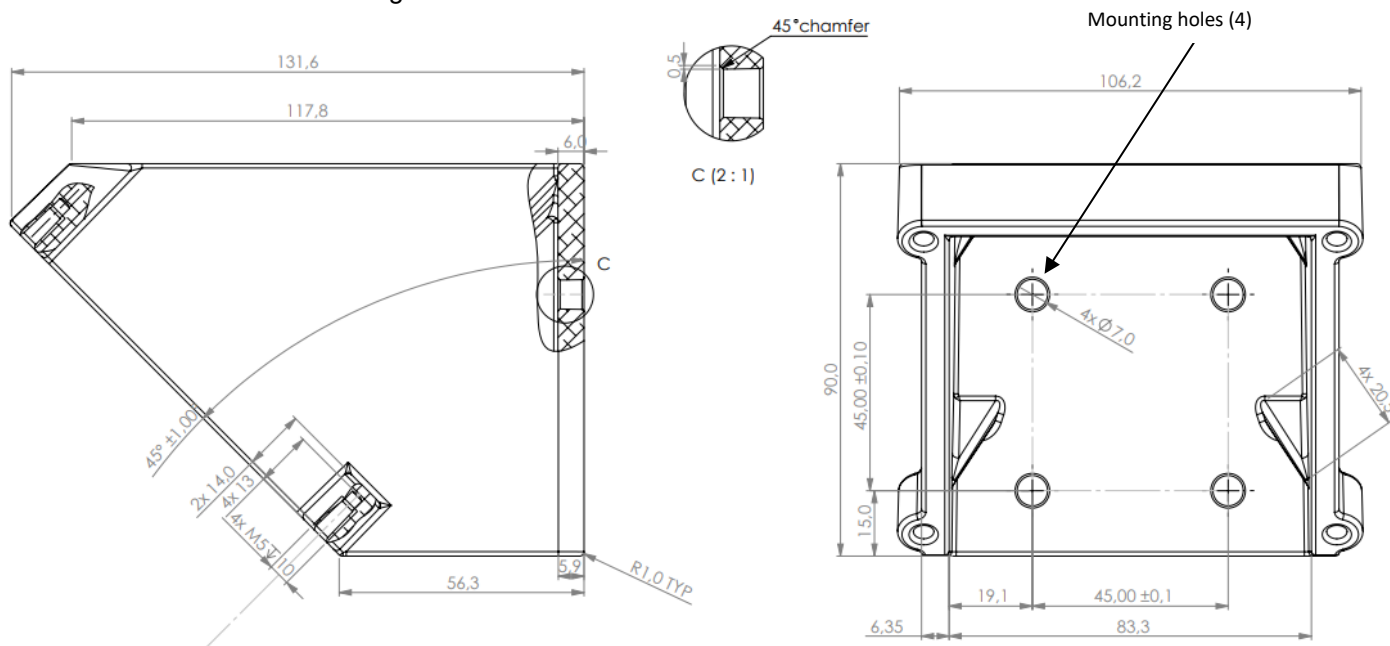

Fixed Mounting Bracket

