

# MultiSensor with SelfVerify - BH-520/EXE

Interactive fire detection systems

Product datasheet

## Declaration of conformity and instructions

### Features

- Interactive
- Multisensor detectors ensures fast response to various fire developments
- Smoke detector for detection of combustion gases mainly consisting of visible (large) particles. Heat sensor assisted for early detection of flaming fires
- Comprises DYFI+ adaptive and self learning function
- SelfVerify function for reduced maintenance/ testing and increased reliability
- Built in thermistor for reading of temperature at the detector point
- Selective towards misleading environmental phenomena that in a traditional system would lead to an unwanted fire alarm
- Short circuit isolator in each detector
- Additional coating of PCB
- Automatic addressing
- Proven technology
- RIME approved
- Designed to meet the requirement of the major maritime classification societies

### Applications

BH-520/EXE is a multisensor detector for use in hazardous area zone 1 or 2. A rise in temperature will change the detection platform by increasing the smoke sensitivity in order to improve the detection of combustion gases from flaming fires producing barely a minimum of visible smoke particles. The MultiSensor principle combined with advanced signal processing in the detector ensures an early response to any type of fire development.

BH-520/EXE is designed for use with Autronica's interactive fire detection systems. Additional coating of PCB combined with the adaptivity and the all round smoke sensitivity of BH-520/EXE makes this detector suitable for maritime applications where there is a potential flaming or/and smouldering fire hazard.

The BH-520/EXE detector is tested by RIME for increased safety "e", according to Japanese standard JIS F8009-1998 and JIS C0934-1993.

### Principle

Dual - 2 - sensor detector. Photoelectric, operating on the light scatter principle and temperature measurement by means of a thermistor.



SelfVerify: the detector's ability to initiate alarm at correct amount of smoke is regularly checked.

### Technical specifications

Weight	165 g
Material	Polycarbonate / ABS
Colour	White
Sensitivity (BH-520/EXE)	Acc. to EN 54-5/EN 54-9
Voltage	10 - 27 VDC
Current consumption Stand by:	< 0,3mA
Environm. requirement	EN 54-7
Degree of protection	IP44D
Working temperature	- 20 - + 70°C
Storage temperature	- 55 - + 70°C
Humidity (non condensing)	Max. 95% RH
Maintenance	None
Service	Replace if faulty
Certificates	See website
RIME certificates	DNV A-7762 NK 4QE150N
Directive and standards	JIS F8009-1998 JIS C0934-1993 89/336/EEC (EMC) Emission: EN 500814:1992 Immunity: EN 50130-4: 1995 EN 61000-6-2: 1999



Part number	Description
116-BWA-100	Detector base
116-BHH-520/EXE	Detector head, RIME approved
116-BWP-100/20	Optional conduit box for M20 glands
116-BWP-100/25	Optional conduit box for M25 glands

### Connections

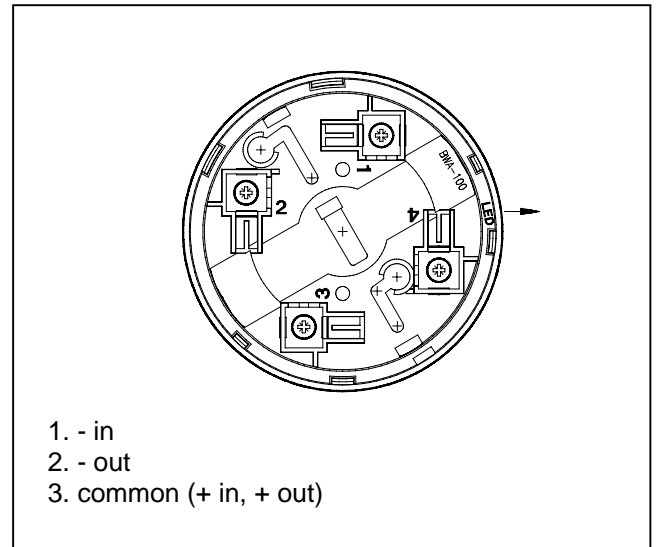

### Dimensions

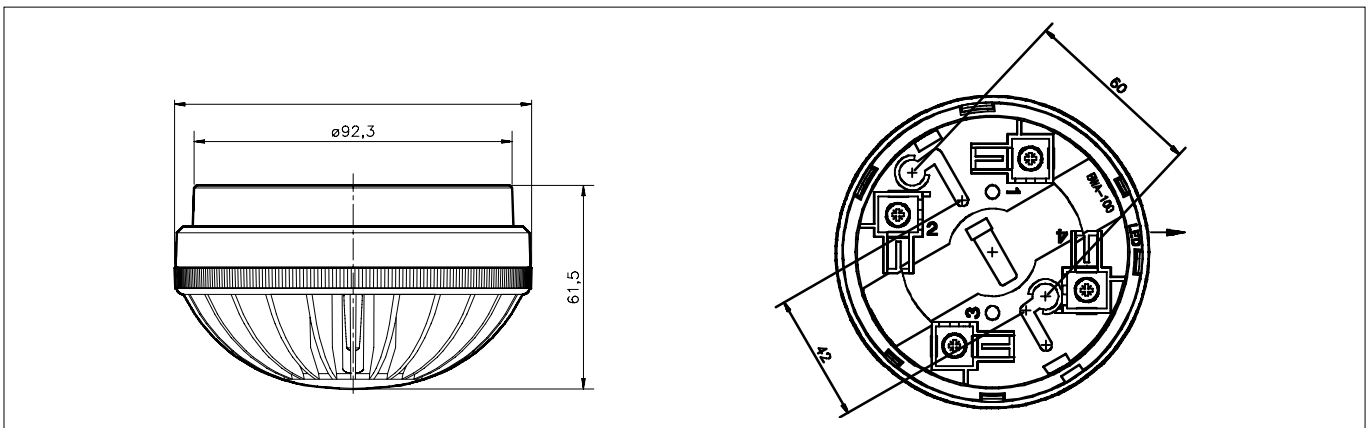

#### AUTRONICA FIRE AND SECURITY AS

Head office, NO-7483 Trondheim, Norway Tel: +47 73 58 25 00, fax: +47 73 58 25 01, e-mail: [info@autronicafire.no](mailto:info@autronicafire.no)  
 Oil and Gas division, Stavanger, Norway Tel: +47 51 84 09 00, fax: +47 51 84 09 99  
 Maritime division, Spikkestad, Norway Tel: +47 31 29 55 00, fax: +47 31 29 55 01

Visit Autronica Fire and Security AS' website: [www.autronicafire.com](http://www.autronicafire.com)